

Item # 48

Humboldt County, California
APN: 110-021-002-000

Humboldt, CA, 2006-2007 - 110-021-002-000 (Alt: 110-021-02), 7813 SHELTER COVE RD, WHITETHORN CA 9596

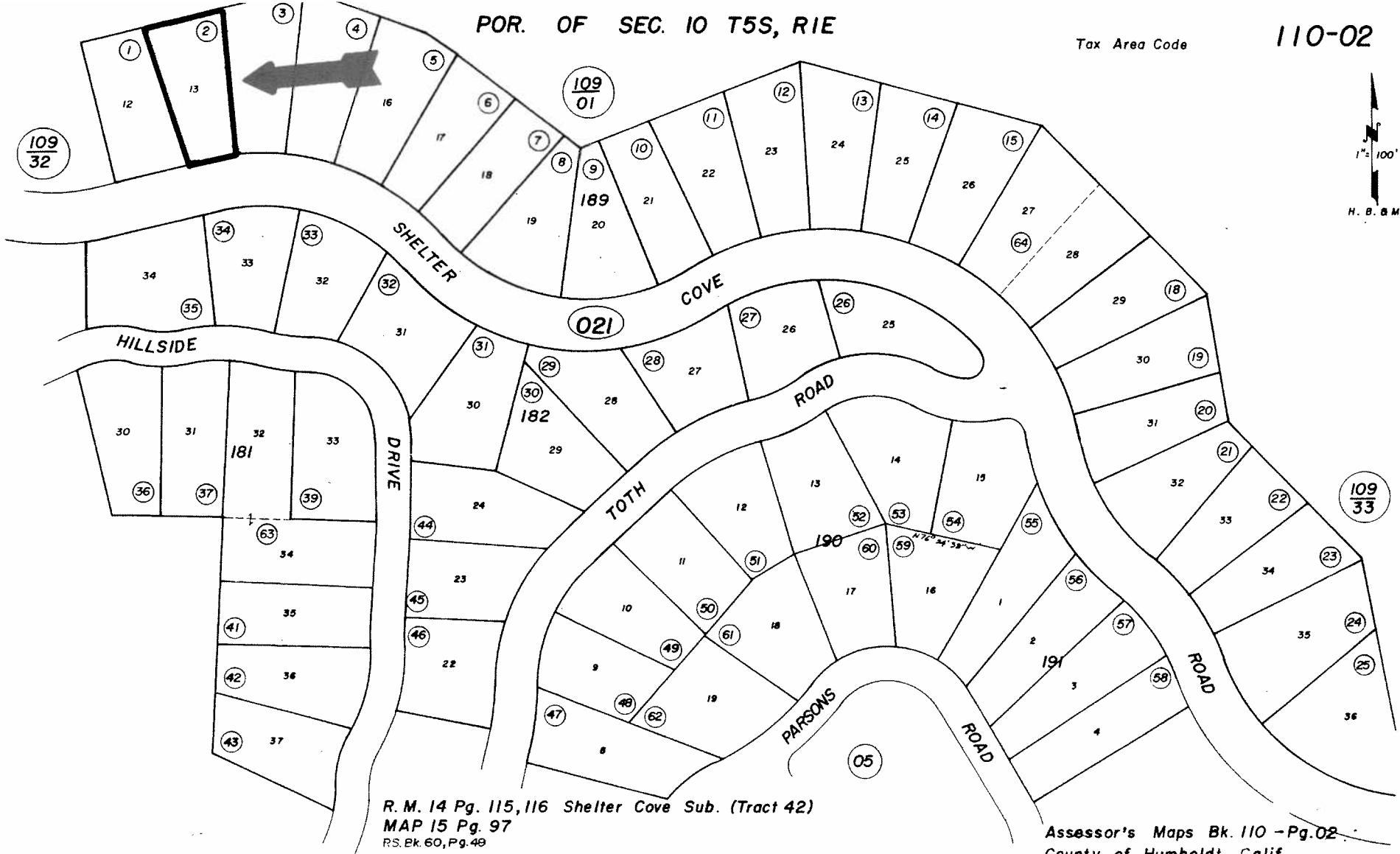

POR. OF SEC. 10 T5S, R1E

Tax Area Code

110-02

109
32

109
01

021

182

181

190

109
33

R. M. 14 Pg. 115, 116 Shelter Cove Sub. (Tract 42)
MAP 15 Pg. 97
R.S. Bk. 60, Pg. 49

Assessor's Maps Bk. 110 -Pg. 02
County of Humboldt, Calif.

NOTE - Assessor's Block Numbers Shown in Ellipses
Assessor's Parcel Numbers Shown in Circles

MAY 24 2004

This is a copy of an county tax map. The Seller and Auctioneer makes no warranties regarding; map accuracy, land use restrictions, legal or physical access, road improvements, or any lack thereof. Personally inspect the parcel prior to the auction.