

Humboldt, CA, 2006-2007 - 109-091-029-000 (Alt: 109-091-29), 713 MUSKRAT CIR, WHITETHORN CA 95589-9198, Sheet: 1 of 1

172

Item # 40

Humboldt County, California
APN: 109-091-029-000

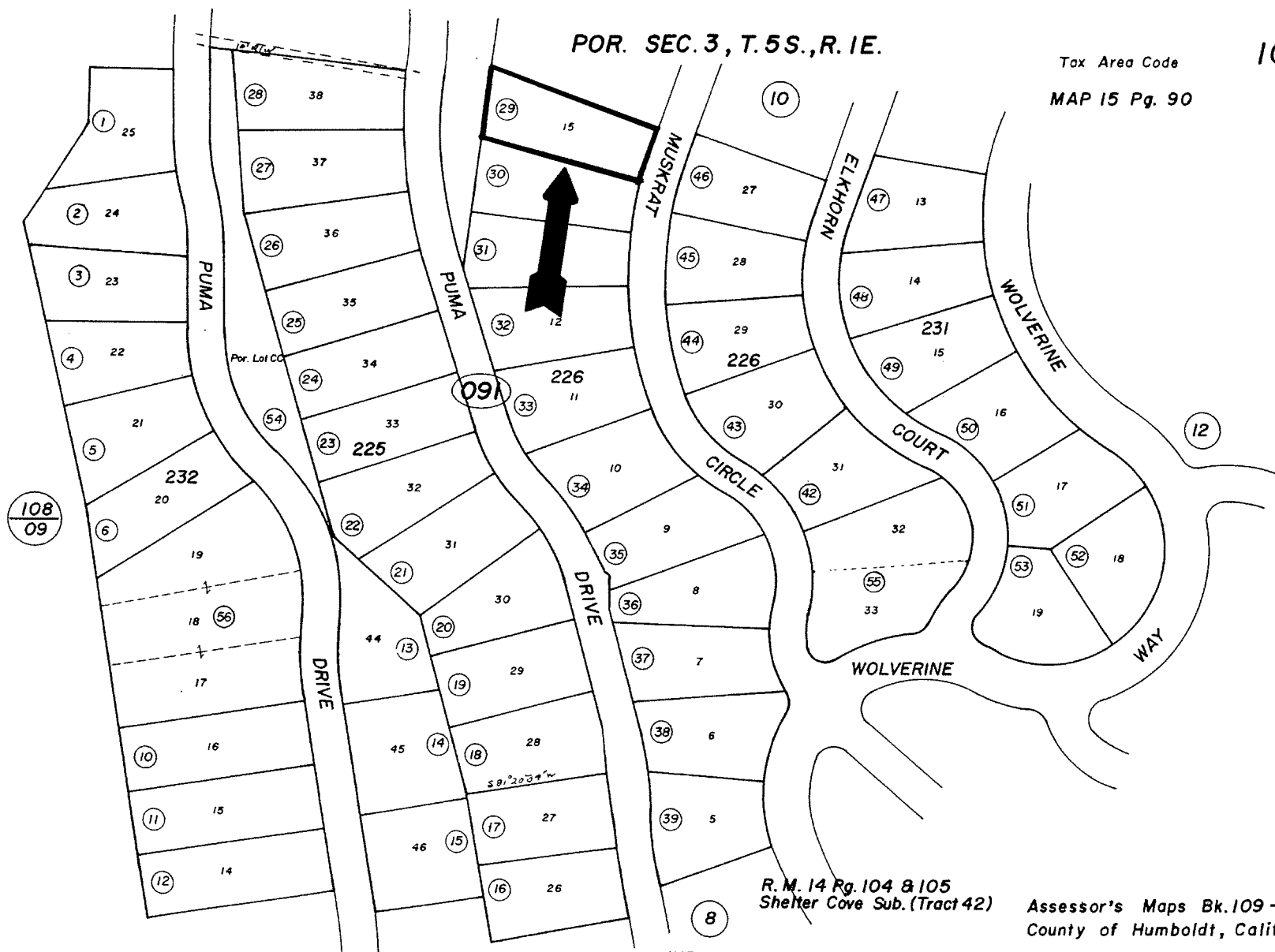

Tax Area Code **109-09**
MAP 15 Pg. 90



R. M. 14 Pg. 104 & 105
Shelter Cove Sub. (Tract 42)

Assessor's Maps Bk. 109 - Pg. 09
County of Humboldt, Calif.

NOTE - Assessor's Block Numbers Shown in Ellipses
Assessor's Parcel Numbers Shown in Circles

NOV 05 2001

This is a copy of a county tax map. The Seller and Auctioneer makes no warranties regarding; map accuracy, land use restrictions, legal or physical access, road improvements, or any lack thereof. Personally inspect the parcel prior to the auction.