

Item # 22

San Bernardino County, California

APN: 0619-161-11-0000

THE MAP IS THE BEST COPY OF THE ORIGINAL RECORD.

S.1/2, S.E.1/4, N.W.1/4 Fractional Sec.19, T.1N.,R.9E., S.B.B.&M.

City of Twentynine Palms 0619 - 16
Tax Rate Area
18015

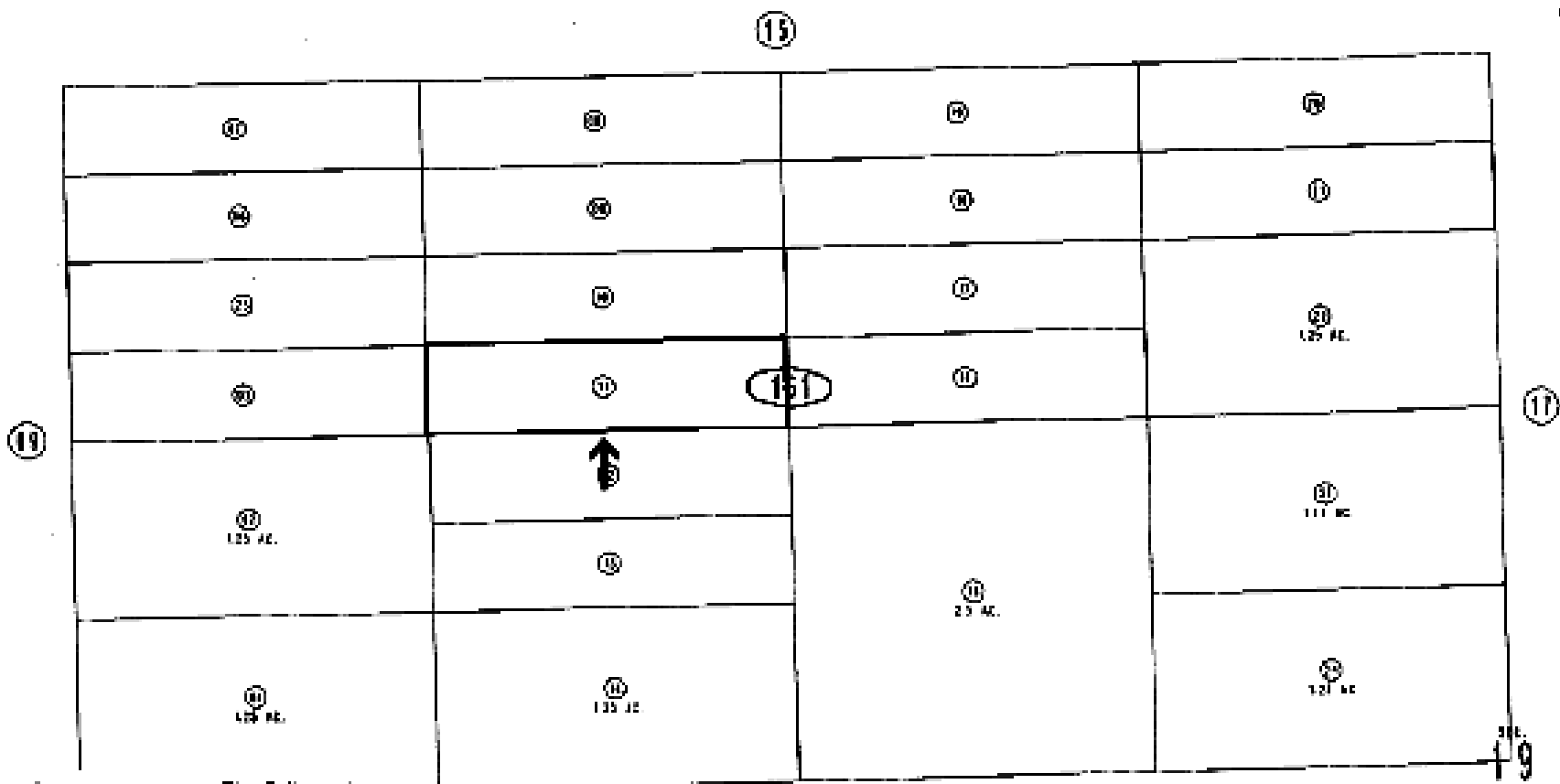

This is a copy of an county tax map. The Seller and Auctioneer makes no warrants regarding; map accuracy, land use restrictions, legal or physical access, road improvements, or any lack thereof. Personally inspect the parcel prior to the auction.

February 2005

Assessor's Map
Book 0619 Page 16
San Bernardino County

316
19
MAY 16 2005
REV 200